

Wylfa Newydd Project

Volume 2: Plans, Sections and Drawings (Part 10/19)

2.7 A5025 Off-line Highway Improvements – Section 1

PINS Reference Number: EN010007

Application Reference Number: 2.7

June 2018

Revision 1.0

Regulation Number: 5(2)(o)

Planning Act 2008

Infrastructure Planning (Applications: Prescribed Forms and Procedure) Regulations 2009

Contents

WN0902-HZDCO-OHW-DRG-00001	A5025 OFF-LINE HIGHWAY IMPROVEMENTS, SECTION 1 - VALLEY, EXISTING SITE PLAN
WN0902-HZDCO-OHW-DRG-00002	A5025 OFF-LINE HIGHWAY IMPROVEMENTS, SECTION 1 - VALLEY, PROPOSED GENERAL, ARRANGMENT PLAN (SHEET 1)
WN0902-HZDCO-OHW-DRG-00003	A5025 OFF-LINE HIGHWAY IMPROVEMENTS, SECTION 1 - VALLEY, PROPOSED GENERAL, ARRANGMENT PLAN (SHEET 2)
WN0902-HZDCO-OHW-DRG-00004	A5025 OFF-LINE HIGHWAY IMPROVEMENTS, SECTION 1 - VALLEY, PROPOSED SITE CLEARANCE PLAN
WN0902-HZDCO-OHW-DRG-00005	A5025 OFF-LINE HIGHWAY IMPROVEMENTS, SECTION 1 - VALLEY, PROPOSED DRAINAGE PLAN, SHEET 1
WN0902-HZDCO-OHW-DRG-00006	A5025 OFF-LINE HIGHWAY IMPROVEMENTS, SECTION 1 - VALLEY, PROPOSED DRAINAGE PLAN, SHEET 2
WN0902-HZDCO-OHW-DRG-00007	A5025 OFF-LINE HIGHWAY IMPROVEMENTS, SECTION 1 - VALLEY, PROPOSED DRAINAGE, CATCHMENT PLAN
WN0902-HZDCO-OHW-DRG-00008	A5025 OFF-LINE HIGHWAY IMPROVEMENTS, SECTION 1 - VALLEY, PROPOSED CROSS SECTIONS, 1A-A & 1B-B
WN0902-HZDCO-OHW-DRG-00068	A5025 OFF-LINE HIGHWAY IMPROVEMENTS, STANDARD DETAILS, BOUNDARY DETAILS
WN0902-HZDCO-OHW-DRG-00069	A5025 OFF-LINE HIGHWAY IMPROVEMENTS, STANDARD DETAILS, DRAINAGE, SHEET 1
WN0902-HZDCO-OHW-DRG-00070	A5025 OFF-LINE HIGHWAY IMPROVEMENTS, STANDARD DETAILS, DRAINAGE, SHEET 2

NOT PROTECTIVELY MARKED

NOTES

1. Existing ground levels based on topographical survey information from surveys undertaken.

LEGEND

— Order Limits

— Existing Overhead Services

1.0	MARCH 2018	FOR DCO SUBMISSION	HNPWL	HNPWL	HNPWL
Rev	Rev. Date	Purpose of revision	Drawn	Checked	Apprv'd

FOR INFORMATION



HORIZON
NUCLEAR POWER

Sunrise House, 1420 Charlton Court, Gloucester Business Park, Gloucester, GL3 4AE, UK
Freephone: 0845 300 6816 Email: info@horizonnuclearpower.com

Project

WYLFA NEWYDD
DCO PROJECT

Drawing Title

A5025 OFF-LINE HIGHWAY IMPROVEMENTS

SECTION 1 - VALLEY

EXISTING SITE PLAN

Regulation 5 (2) (o)

Security Status

NOT PROTECTIVELY MARKED

Scale	1:2000	Sheet Size	A1	Sheet(s)	1 of 1
Drawing Number					Rev
WN0902-HZDCO-OHW-DRG-00001					1.0

© Copyright Horizon Nuclear Power Wylfa Limited. Not to be reproduced (in full or part) without prior permission of Horizon Nuclear Power Wylfa Limited.

Atgynhychwyd o fapiau'r Arolwg Ordans gyda chaniatâd Rheolwr Llyfrfa Ei Mawrhydi © Hawlfraint y Goron. Mae atgynhychu heb ganiatâd yn torri hawlfraint y Goron a gallech gael eich erlyn neu gallai achos sifil gael ei ddwyn yn eich erbyn. Rhif Trwydded yr Arolwg Ordans 100051118.

Reproduced from Ordnance Survey mapping with the permission of the Controller of Her Majesty's Stationery Office
© Crown copyright. Unauthorised reproduction infringes Crown copyright and may lead to prosecution or civil proceedings. Ordnance Survey Licence number 100051118.

A graphic scale bar for a 1:2000 scale. The bar is marked with distances from 0 to 200 meters in increments of 20 meters. The text 'SCALE 1:2000' is written below the bar.



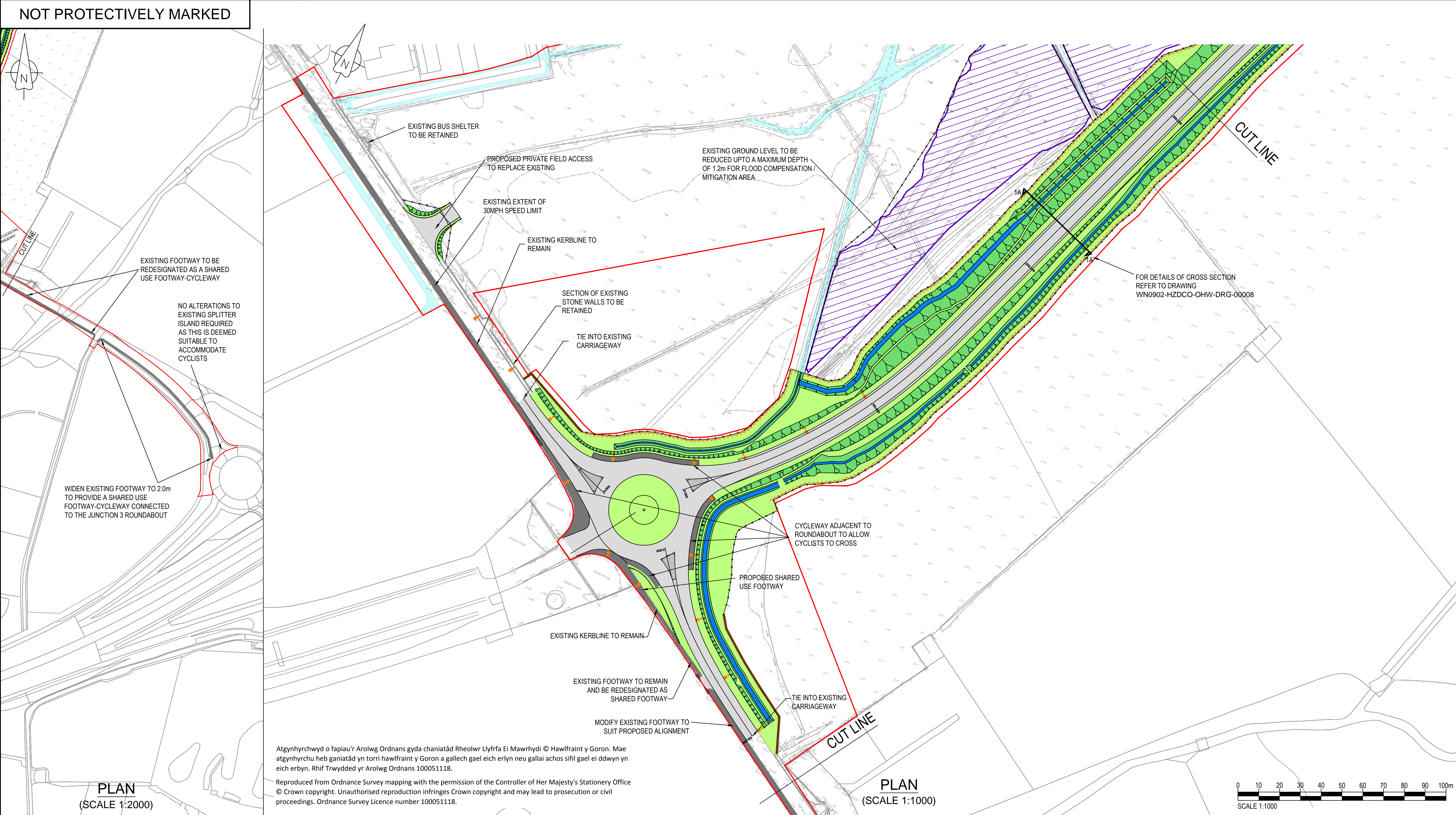











NOT PROTECTIVELY MARKED

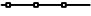

NOTES

1. All dimensions in metres unless stated otherwise.
2. All levels in metres unless stated otherwise.
3. All earthworks batter slopes are shown at a gradient of 1 in 2.5.
4. Existing ground levels based on topographical survey information from surveys undertaken.
5. The proposed carriageway width is 7.3m wide with 1.0m hardstrips on both sides of the carriageway providing a 9.3m total paved width.
6. Road alignment geometry has been designed in accordance with DMRB td 9/93.
7. Roundabout geometry designed in accordance with DMRB td 16/07.
8. For details of proposed drainage refer to drawings
WN9002-HZDCO-CHV-DRG-00005 & 00006.
9. Lighting to be provided for a minimum of 105m on each approach to the roundabout and the lighting will comprise 10m high galvanised steel columns, brackets and lanterns at 30m centres.
10. For details of landscaping and planting refer to Design Access Statement (DAS).

LEGEND

-  Order Limits
-  Existing overhead services
-  Proposed carriageway
-  Proposed shared use footway-cycleway
-  Proposed splitter islands
-  Proposed verge / landscaping
-  Proposed earthworks slopes
-  Existing watercourse
-  Proposed highway boundary fence
-  Proposed stone wall
-  Proposed hedgerow
-  Proposed gated private means of access
-  Proposed land drainage ditch
-  Proposed street lighting column
-  Flood mitigation area

REFERENCE DRAWINGS

WN0902-HZDCO-OHW-DRG-00003 - SHEET 2

PROPOSED CROSS SECTIONS

PROPOSED CROSS SECTIONS
WN0902-HZDCO-OHW-DRG-00008

1.0	MAY 2018	FOR DCO SUBMISSION	HNPWL	HNPWL	HNPWL
Rev	Rev. Date	Purpose of revision	Drawn	Checked	Apprv'd

FOR APPROVAL

HORIZON
NUCLEAR POWER

Sunrise House, 1420 Charlton Court, Gloucester Business Park, Gloucester, GL3 4AE, UK
Freephone: 0845 300 6816 Email: info@horizonnuclearpower.com

Project

WYLFA NEWYDD
DCO PROJECT

Drawing Title

A5025 OFF-LINE HIGHWAY IMPROVEMENTS

SECTION 1 - VALLEY

PROPOSED GENERAL

Security Status
NOT PROTECTIVELY MARKED

Scale	AS SHOWN	Sheet Size	A1	Sheet(s)	1 of 1
Drawing Number					Day

Drawing Number	Rev
WN0902-HZDCO-OHW-DRG-00002	1.0

© Copyright Horizon Nuclear Power Wylfa Limited. Not to be reproduced (in full or part) without prior permission of Horizon Nuclear Power Wylfa Limited.

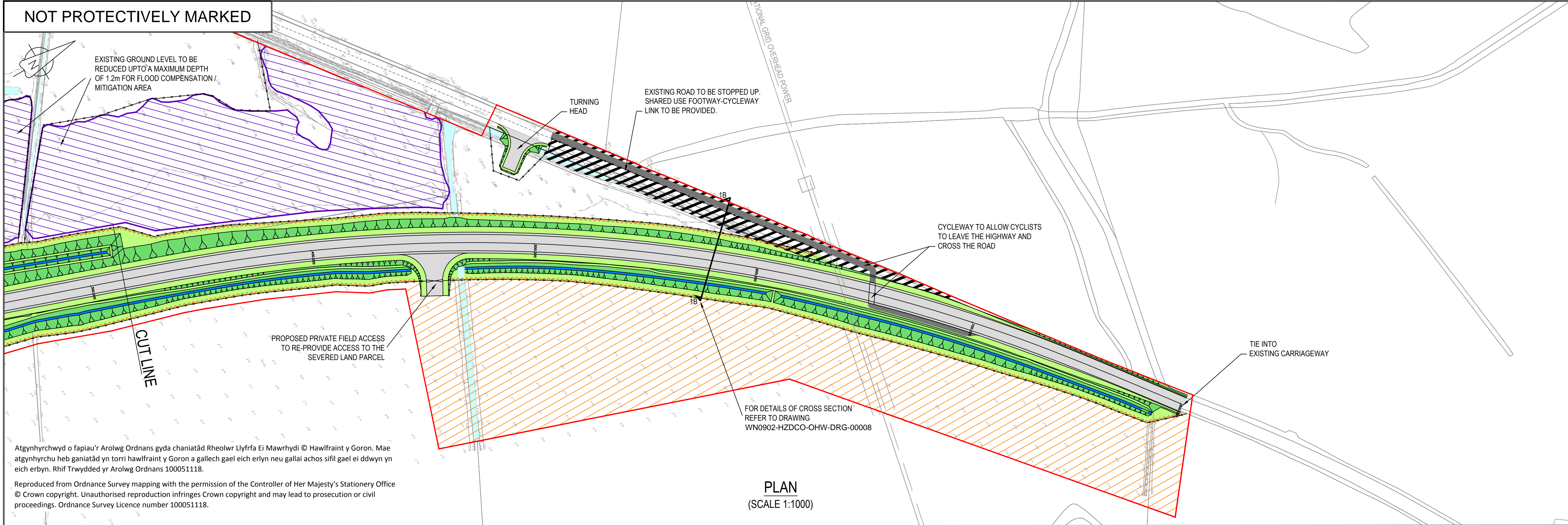

NOTES

LEGEND

REFERENCE DRAWINGS

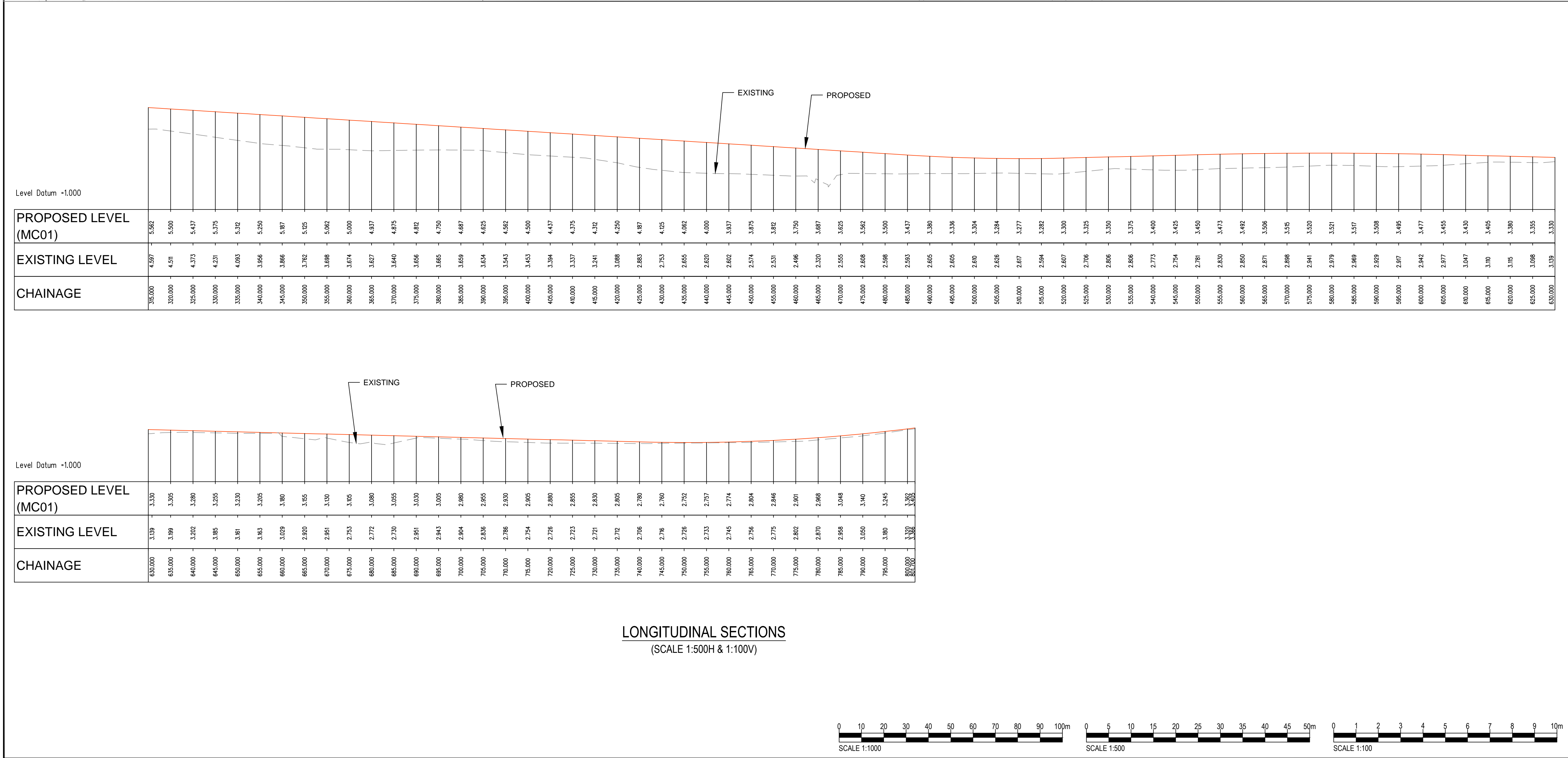

FOR APPROVAL

HORIZON

NUCLEAR POWER

Sunrise House, 1420 Charlton Court, Gloucester Business Park, Gloucester, GL3 4AE, UK
Freephone: 0845 300 6816 Email: info@horizonnuclearpower.com

Project

WYLFA NEWYDD
DCO PROJECT

Drawing Title

A5025 OFF-LINE HIGHWAY IMPROVEMENTS
SECTION 1 - VALLEY
PROPOSED GENERAL
ARRANGEMENT PLAN - SHEET 2

Regulation 5 (2) (o)

NOT PROTECTIVELY MARKED

Scale

AS SHOWN

Sheet Size

A1

Sheet(s)

1 of 1

Drawing Number

WN0902-HZDCO-OHW-DRG-00003

Rev

1.0

© Copyright Horizon Nuclear Power Wylfa Limited. Not to be reproduced (in full or part) without prior permission of Horizon Nuclear Power Wylfa Limited.



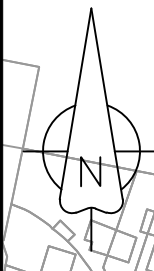



NOT PROTECTIVELY MARKED



NOTES

1. The area shown as 'general site clearance' does not mean that everything within this area is to be cleared. Site clearance will be the minimum required to undertake the works. General site clearance consists of removal of overgrowth in verges, topsoil removal and disposal.
2. Only fencing, hedgerows & gates identified in the key are to be removed as part of the site clearance works.
3. For details of proposed drainage refer to drawings
WN0902-HZDCO-OHW-DRG-00005 & 00006.
4. Important Hedgerow Reference Number (see Schedule 18 of the draft DCO (Application Reference Number: 3.1).

LEGEND

-  Order limits
-  Existing overhead services
-  General site clearance area
-  MSHW Mortar stone wall to be removed
-  TFW Timber post & wire fence to be removed
-  Gate to be removed
-  Important Hedgerow (Hedgerow Regulations 1997)
To be removed

REFERENCE DRAWINGS

1. This drawing is to be read in conjunction with the notes on drawing WN0902-HZDCO-OHW-DRG-00005.
2. WN0902-HZDCO-OHW-DRG-00006.

1.0	MARCH 2018	FOR DCO SUBMISSION	HNPWL	HNPWL	HNPWL
Rev	Rev. Date	Purpose of revision	Drawn	Checked	Apprv'd

FOR APPROVAL

HORIZON
NUCLEAR POWER

Sunrise House, 1420 Charlton Court, Gloucester Business Park, Gloucester, GL3 4AE, UK
Freephone: 0845 300 6816 Email: info@horizonnuclearpower.com

Project

WYLFA NEWYDD DCO PROJECT

Drawing Title

A5025 OFF-LINE HIGHWAY IMPROVEMENTS
SECTION 1 - VALLEY
PROPOSED SITE CLEARANCE PLAN

Regulation 5 (2) (o)

Security Status NOT PROTECTIVELY MARKED

Scale	1:2000	Sheet Size	A1	Sheet(s)	1 of 1
Drawing Number					Rev
WN0902-HZDCO-OHW-DRG-00004					1.0

© Copyright Horizon Nuclear Power Wylfa Limited. Not to be reproduced (in full or part) without prior permission of Horizon Nuclear Power Wylfa Limited.

Atgynhychwyd o fapiau'r Arolwg Ordnans gyda chaniatâd Rheolwr Llyfrau Ei Mawrhydi © Hawffraint y Goron. Mae atgynhychiad heb caniatâd yn torri hawffraint y Goron a gallech gael eich erlyn neu galfai achos sifil gael ei ddwyn yn eich erbyn. Rhif Trwydded yr Arolwg Ordnans 100051118.

Reproduced from Ordnance Survey mapping with the permission of the Controller of Her Majesty's Stationery Office © Crown copyright. Unauthorised reproduction infringes Crown copyright and may lead to prosecution or civil proceedings. Ordnance Survey Licence number 100051118.

NOT PROTECTIVELY MARKED

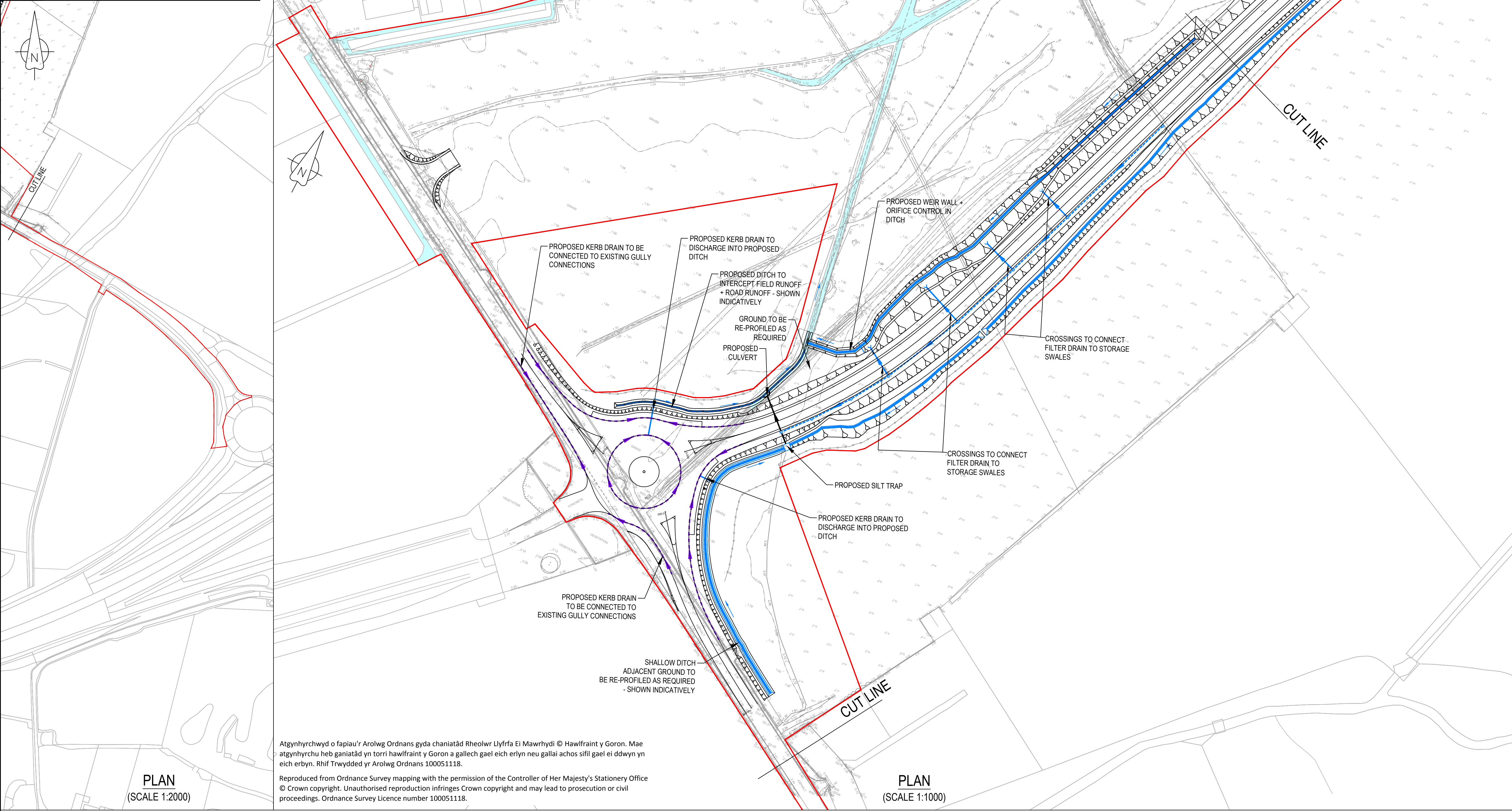

NOTES

1. All levels in metres unless stated otherwise.
2. Earthwork batter slopes are shown at a gradient of 1 in 2.5.
3. Pond batter slopes are shown at a gradient of 1 in 3.
4. Existing ground survey is based on the highway topographical survey (dated 23.01.2012) and additional land topographical survey (dated Dec 2014 and June 2016).
5. Pond volumes are based on a 1 in 100 year return period plus 30% climate change.
6. Ponds to be located outside of the flood plain.
7. Drainage layouts are indicative for information only and are subject to detailed design and modelling.
8. Highway drainage has been designed in accordance with the guidance on storm return periods in DMRB volume 4 section 2 part 3 HD 33/06.
9. Gradients of filter drains typically follow the longitudinal fall of the highway with a minimum cover of 1.2m.
10. Filter drain inspection chambers shall be located at regular Intervals and at connection points. The spacing between inspection chambers shall not exceed 80m.
11. Drainage outfall locations and levels are based on topographical survey information data.

LEGEND

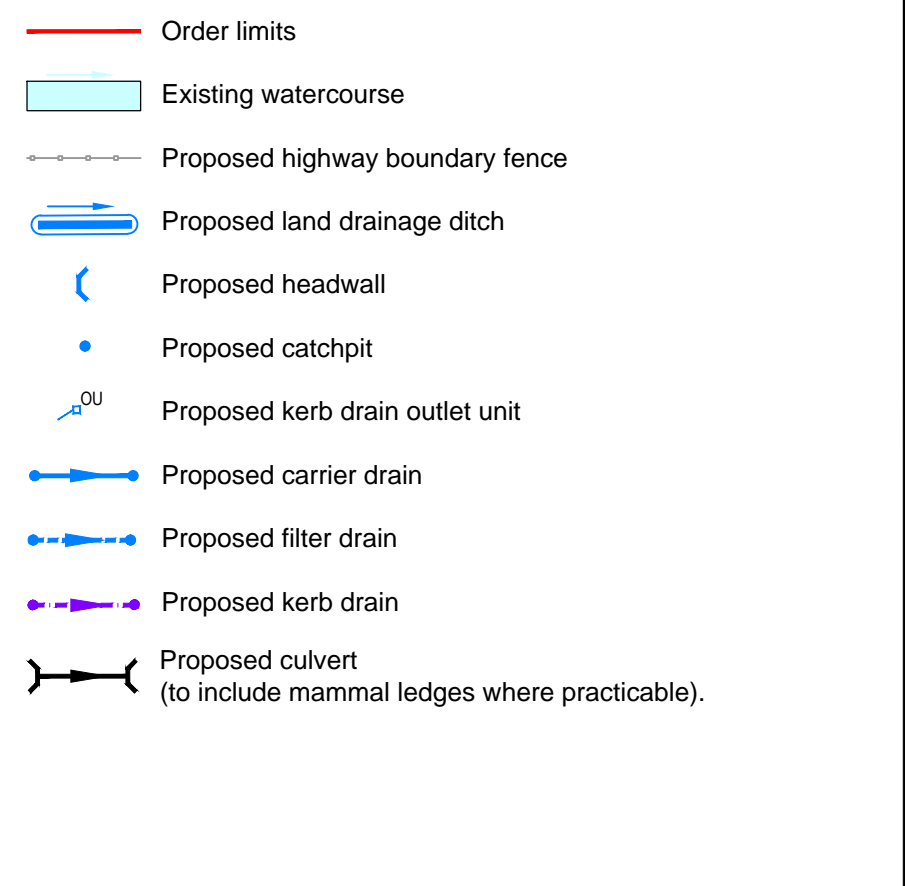

REFERENCE DRAWINGS

WN0902-HZDCO-OHW-DRG-00006 - SHEET 2

1.0	MARCH 2018	FOR DCO SUBMISSION	HNPWL	HNPWL	HNPWL
Rev	Rev. Date	Purpose of revision	Drawn	Checked	Approved

FOR APPROVAL

FOR APPROVAL

HORIZON
NUCLEAR POWER

Sunrise House, 1420 Charlton Court, Gloucester Business Park, Gloucester, GL3 4AE, UK
Freephone: 0845 300 6816 Email: info@horizonnuclearpower.com

Project

WYLFA NEWYDD
DCO PROJECT

Drawing Title

A5025 OFF-LINE HIGHWAY IMPROVEMENTS
SECTION 1 - VALLEY
PROPOSED DRAINAGE PLAN
SHEET 1

Regulation 5 (2) (o)

Security Status NOT PROTECTIVELY MARKED

Scale	AS SHOWN	Sheet Size	A1	Sheet(s)	1 of 1
-------	----------	------------	----	----------	--------

Drawing Number	Rev
WN0902-HZDCO-OHW-DRG-00005	1.0

© Copyright Horizon Nuclear Power Wylfa Limited. Not to be reproduced (in full or part) without prior permission of Horizon Nuclear Power Wylfa Limited.

NOT PROTECTIVELY MARKED

NOTES

1. All levels in metres unless stated otherwise.
2. Earthwork batter slopes are shown at a gradient of 1 in 2.5.
3. Pond batter slopes are shown at a gradient of 1 in 3.
4. Existing ground survey is based on the highway topographical survey (dated 29.01.2012) and additional land topographical survey (dated Dec 2014 and June 2016).
5. Pond volumes are based on a 1 in 100 year return period plus 30% climate change.
6. Ponds to be located outside of the flood plain.
7. Drainage layouts are indicative for information only and are subject to detailed design and modelling.
8. Highway drainage has been designed in accordance with the guidance on storm return periods in DMRB volume 4 section 2 part 3 HD 33/06.
9. Gradients of filter drains typically follow the longitudinal fall of the highway with a minimum cover of 1.2m.
10. Filter drain inspection chambers shall be located at regular intervals and at connection points. The spacing between inspection chambers shall not exceed 80m.
11. Drainage outfall locations and levels are based on topographical survey information data.

LEGEND

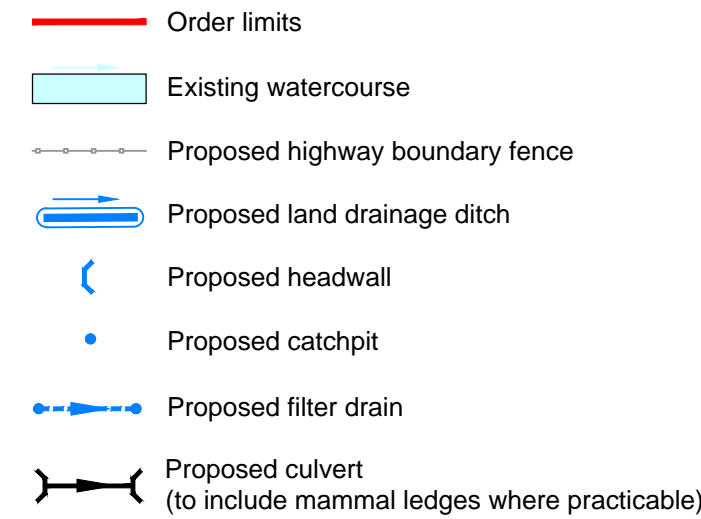

REFERENCE DRAWINGS

WN0902-HZDCO-OHW-DRG-00005 - SHEET 1

1.0	MARCH 2018	FOR DCO SUBMISSION	HNPWL	HNPWL	HNPWL
Rev	Rev. Date	Purpose of revision	Drawn	Checked	Approved

FOR APPROVAL

HORIZON
NUCLEAR POWER

Sunrise House, 1420 Charlton Court, Gloucester Business Park, Gloucester, GL3 4AE, UK
Freephone: 0845 300 6816 Email: info@horizonnuclearpower.com

Sunrise House, 1420 Charlton Court, Gloucester Business Park, Gloucester, GL3 4AE, UK
Freephone: 0845 300 6816 Email: info@horizonnuclearpower.com

Project

WYLFA NEWYDD
DCO PROJECT

A5025 OFF-LINE HIGHWAY IMPROVEMENTS
SECTION 1 - VALLEY
PROPOSED DRAINAGE PLAN
SHEET 2

Regulation 5 (2) (o)

NOT PROTECTIVELY MARKED

Scale	AS SHOWN	Sheet Size	A1	Sheet(s)	1 of 1
-------	----------	------------	----	----------	--------

Drawing Number	Rev
WN0902-HZDCO-OHW-DRG-00006	1.0

© Copyright Horizon Nuclear Power Wylfa Limited. Not to be reproduced (in full or part) without prior permission of Horizon Nuclear Power Wylfa Limited

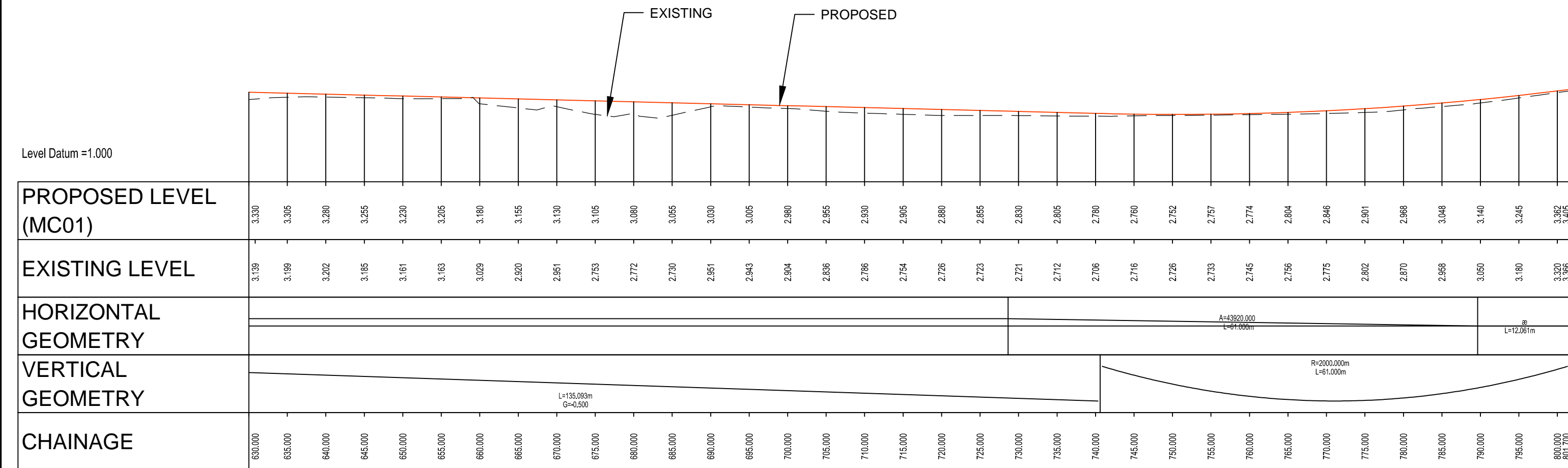
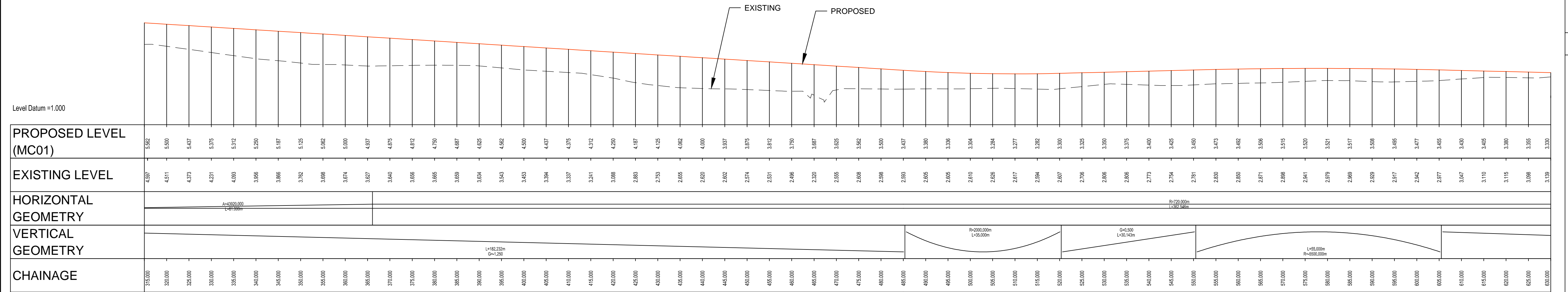
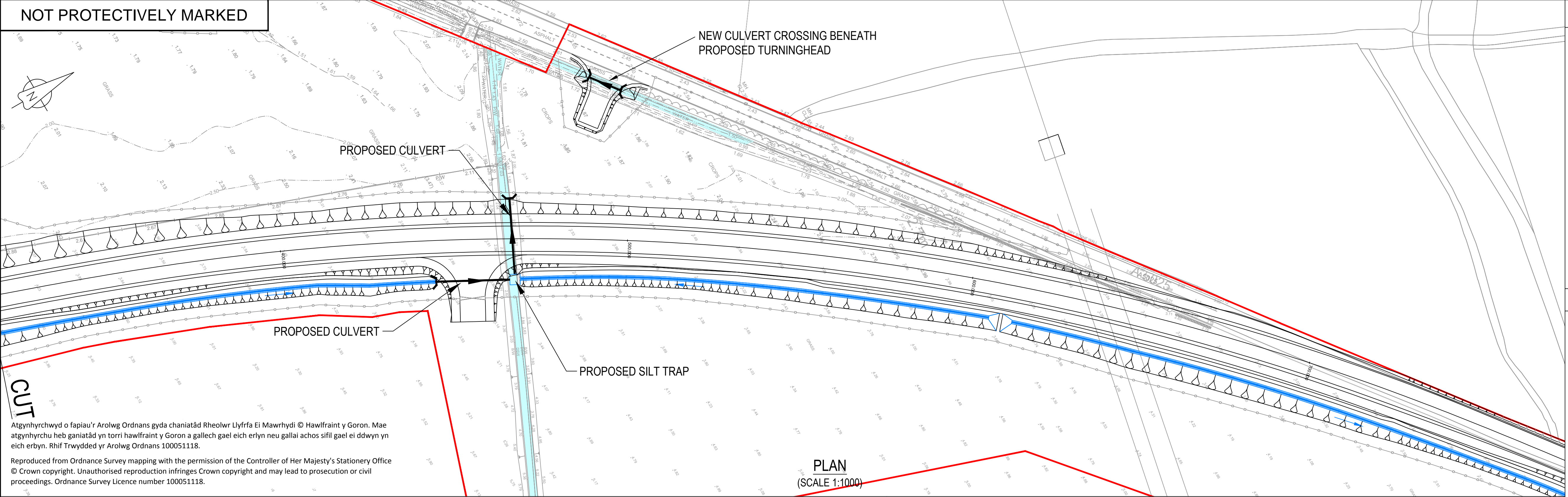

LONGITUDINAL SECTIONS

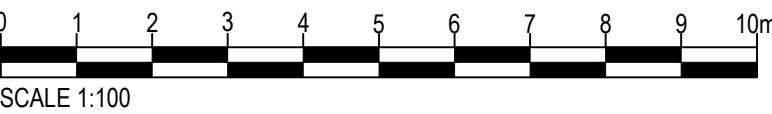
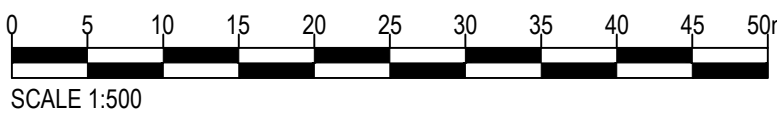
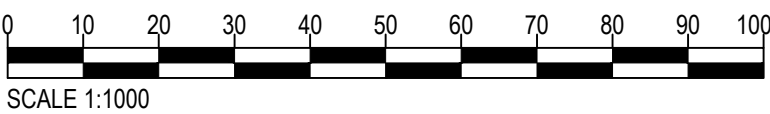

1. Earthwork batter slopes are shown at a gradient of 1 in 2.5.
2. Pond batter slopes are shown at a gradient of 1 in 3.
3. Existing ground survey is based on the highway topographical survey (dated 29.01.2012) and additional land topographical survey (dated Dec 2014 and June 2016).
4. Pond volumes are based on a 1 in 100 year return period plus 30% climate change.
5. Ponds to be located outside of the flood plain.
6. Drainage layouts are indicative for information only and are subject to detailed design and modelling.
7. Highway drainage has been designed in accordance with the guidance on storm return periods in DMRB volume 4 section 2 part 3 HD 33/06.
8. Gradients of filter drains typically follow the longitudinal fall of the highway with a minimum cover of 1.2m.
9. Filter drain inspection chambers shall be located at regular intervals and at connection points. The spacing between inspection chambers shall not exceed 80m.
10. Drainage outfall locations and levels are based on topographical survey information.

LEGEND

- Order limits
- Catchment Area 01
- Catchment Area 02
- Catchment Area 03
- Catchment Area 04
- Catchment Area 05
- Catchment Area 06
- Existing watercourse
- Proposed highway boundary fence
- Proposed land drainage ditch
- Proposed headwall
- Proposed catchpit
- Proposed kerb drain outlet unit
- Proposed carrier drain
- Proposed filter drain
- Proposed kerb drain
- Proposed culvert (to include mammal ledges where practicable)

1.0	MARCH 2018	FOR DCO SUBMISSION	HNPWL	HNPWL	HNPWL
Rev	Rev. Date	Purpose of revision	Drawn	Checked	Approved

FOR INFORMATION

HORIZON
NUCLEAR POWER

Sunrise House, 1420 Charlton Court, Gloucester Business Park, Gloucester, GL3 4AE, UK
Freephone: 0845 300 6816 Email: info@horizonnuclearpower.com

Project
**WYLFA NEWYDD
DCO PROJECT**

Drawing Title
**A5025 OFF-LINE HIGHWAY IMPROVEMENTS
SECTION 1 - VALLEY
PROPOSED DRAINAGE
CATCHMENT PLAN**

Regulation 5 (2) (o)

Security Status					
NOT PROTECTIVELY MARKED					
Scale	1:1250	Sheet Size	A1	Sheet(s)	1 of 1
Drawing Number					Rev
WN0902-HZDCO-OHW-DRG-00007					1.0

© Copyright Horizon Nuclear Power Wylfa Limited. Not to be reproduced (in full or part) without prior permission of Horizon Nuclear Power Wylfa Limited.

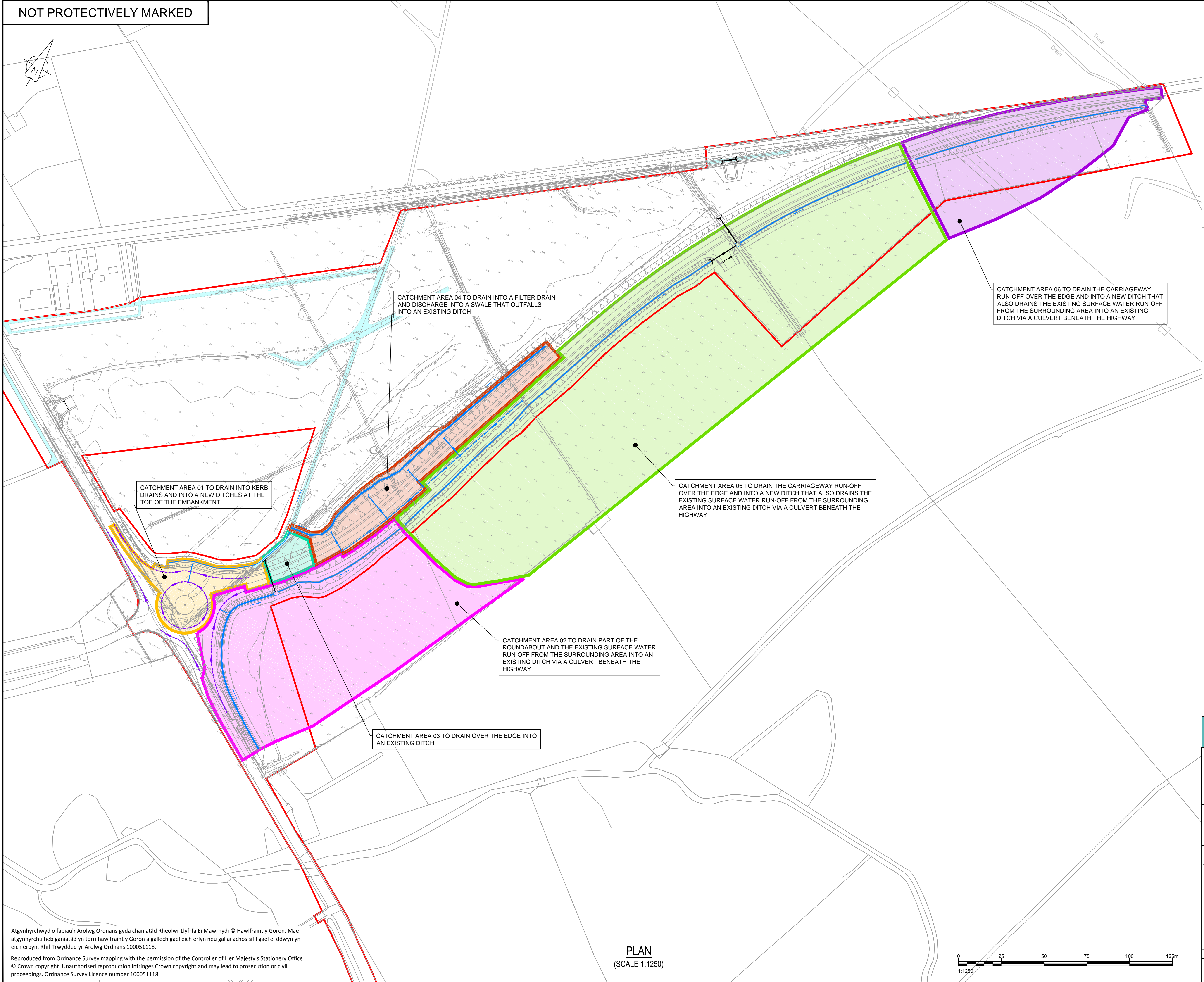

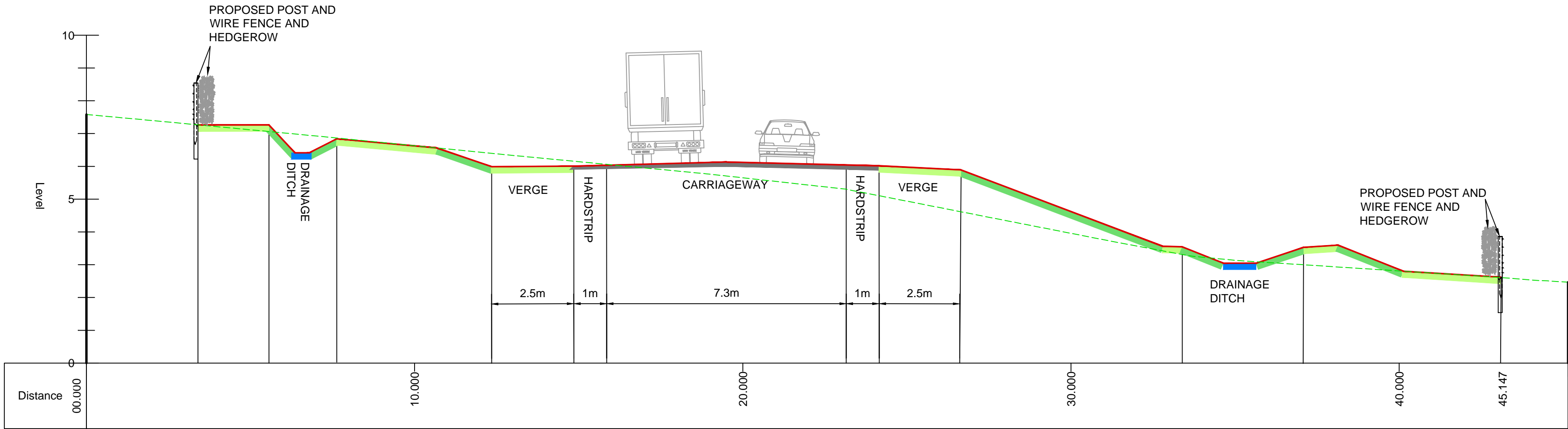

PROPOSED CROSS SECTION 1A-A
(SCALE 1:100)

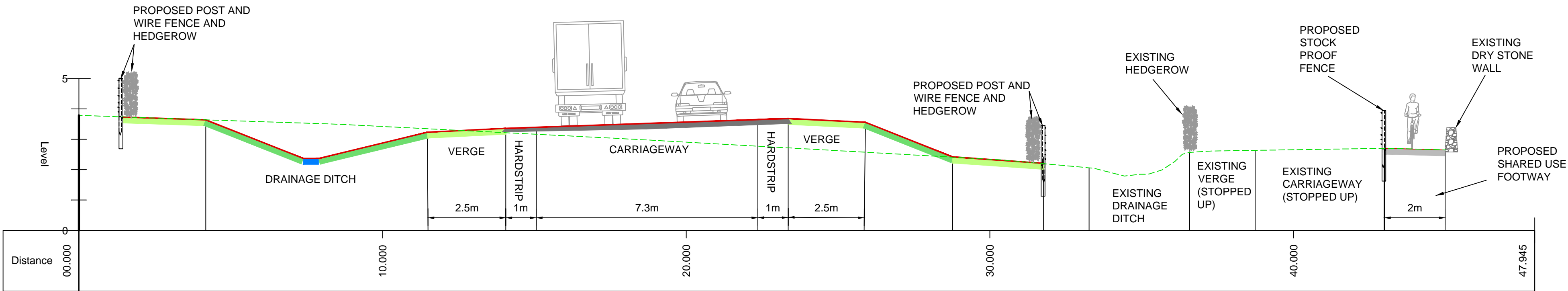

PROPOSED CROSS SECTION 1B-B
(SCALE 1:100)

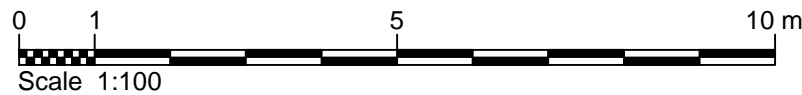

NOTES

1. All dimensions in metres unless stated otherwise.
2. All levels in metres unless stated otherwise.

LEGEND

- Proposed levels
--- Existing levels

REFERENCE DRAWINGS

WN0902-H2DCO-OHW-DRG-00002 - A5025 OFF-LINE HIGHWAYS IMPROVEMENTS SECTION 1 PROPOSED GENERAL ARRANGEMENT PLAN (SHEET1)
WN0902-H2DCO-OHW-DRG-00003 - A5025 OFF-LINE HIGHWAYS IMPROVEMENTS SECTION 1 PROPOSED GENERAL ARRANGEMENT PLAN (SHEET2)

1.0	MARCH 2018	FOR DCO SUBMISSION	HNPWL	HNPWL	HNPWL
Rev	Rev. Date	Purpose of revision	Drawn	Checked	Apprv'd

FOR APPROVAL

HORIZON
NUCLEAR POWER

Sunrise House, 1420 Charlton Court, Gloucester Business Park, Gloucester, GL3 4AE, UK
Freephone: 0845 300 6816 Email: info@horizonnuclearpower.com

Project
**WYLFA NEWYDD
DCO PROJECT**

Drawing Title
**A5025 OFF-LINE HIGHWAY IMPROVEMENTS
SECTION 1 - VALLEY
PROPOSED CROSS SECTIONS
1A-A & 1B-B**

Regulation 5 (2) (o)

NOT PROTECTIVELY MARKED					
Scale	1:100	Sheet Size	A1	Sheet(s)	1 OF 1
Drawing Number	WN0902-HZDCO-OHW-DRG-00008				Rev 1.0

1. All dimensions in metres unless stated otherwise.
2. Only written dimensions are to be used.
3. All timber post & rail fences and timber post & wire fences to have 2 barbed wire strands.
4. For details of timber post & wire fences refer to DMRB MCHW standard detail H1.
4. For details of timber post & 4 rail fences refer to DMRB MCHW standard detail H3.
5. For details of proposed vehicular field access gates refer to DMRB MCHW standard detail H17.
6. For details of timber wicket gate refer to DMRB MCHW standard detail H23.

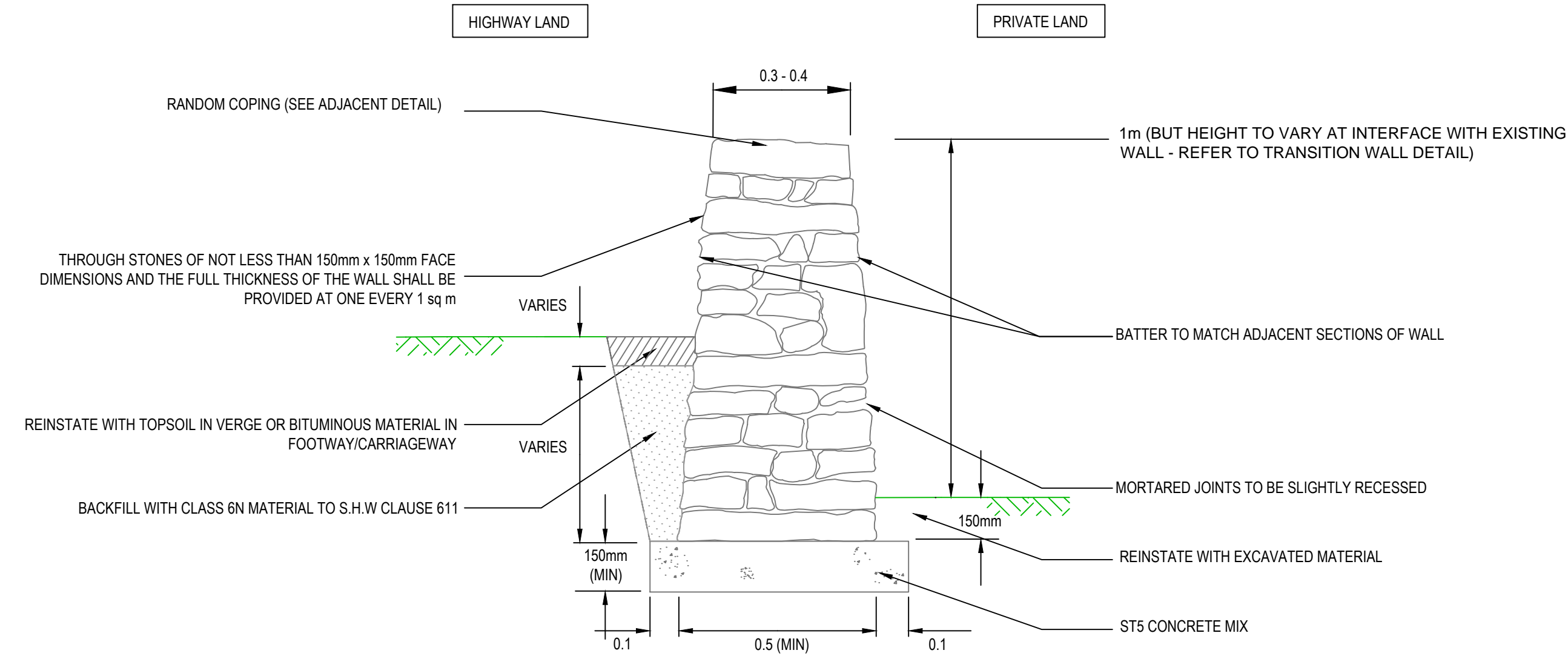

PROPOSED MORTARED STONE WALL (SECTION) (Not to Scale)

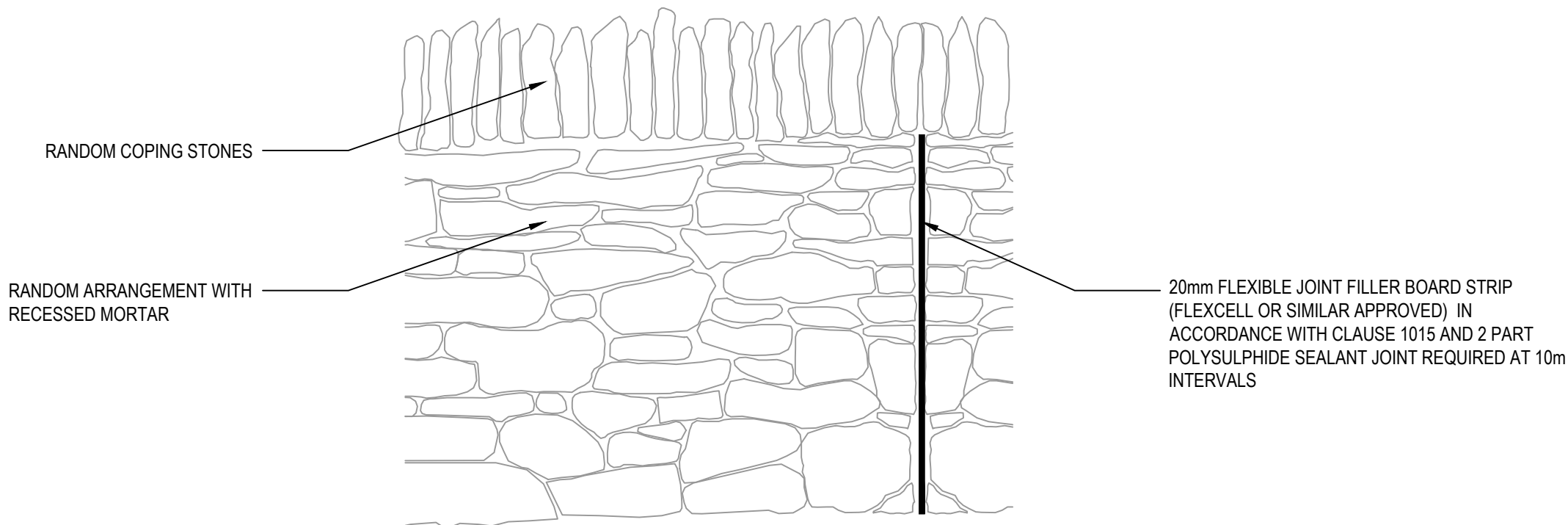

PROPOSED MORTARED STONE WALL (ELEVATION) (Not to Scale)

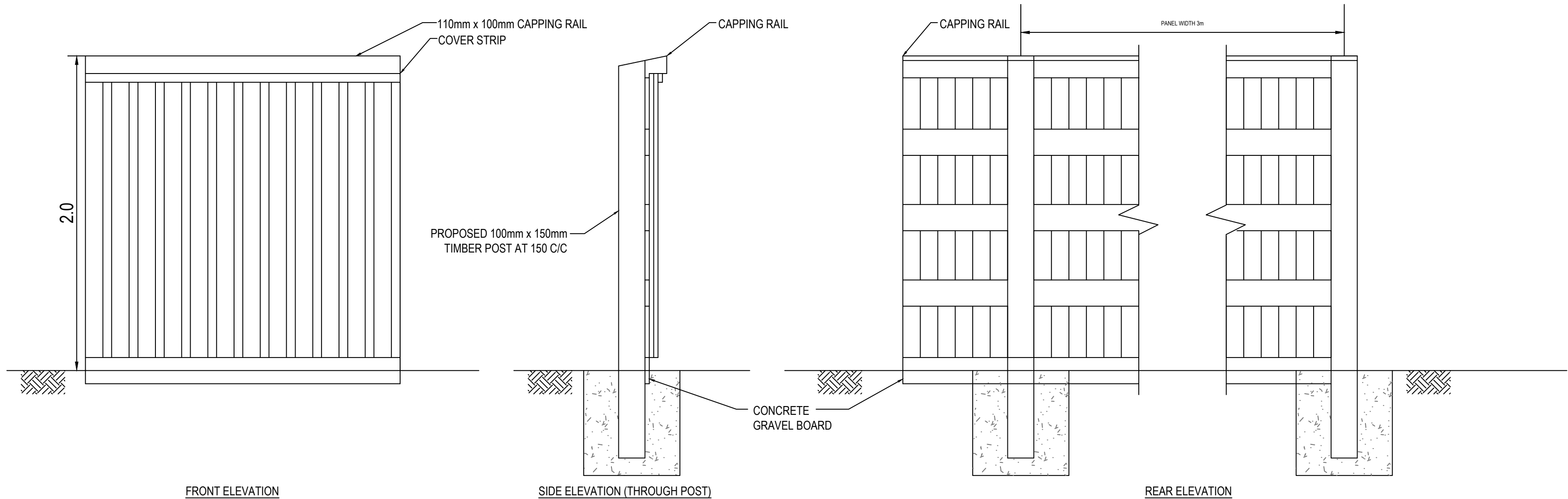

SIDE ELEVATION (THROUGH POST)

REAR ELEVATION

PROPOSED 2.0m NOISEWALL SINGLE SIDED REFLECTIVE TIMBER SOUND SCREEN (Not to Scale)

HIGHWAY LAND

PRIVATE LAND

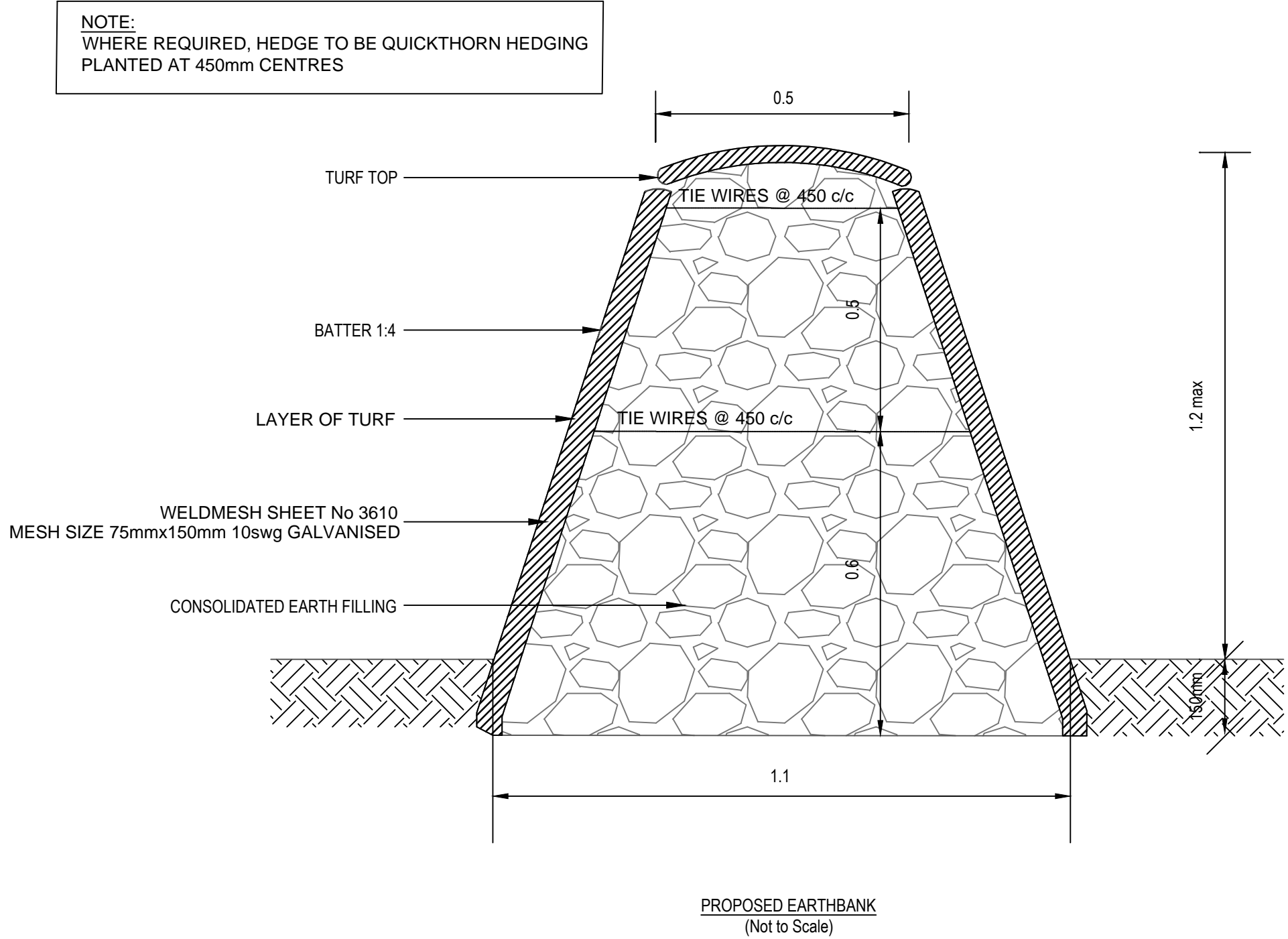

PROPOSED EARTHBANK (Not to Scale)

HEDGEROW TO BE SINGLE SPECIES HAWTHORN (CRATAEGUS MONOGYNA). WHEN REQUIRED THE HEDGEROW IS TO BE LOCATED BETWEEN THE ADJACENT NEW WALL AND PERMANENT STOCK PROOF FENCE. REFER TO SPECIFICATION APPENDIX SERIES 3000 FOR PLANTING SCHEDULE.

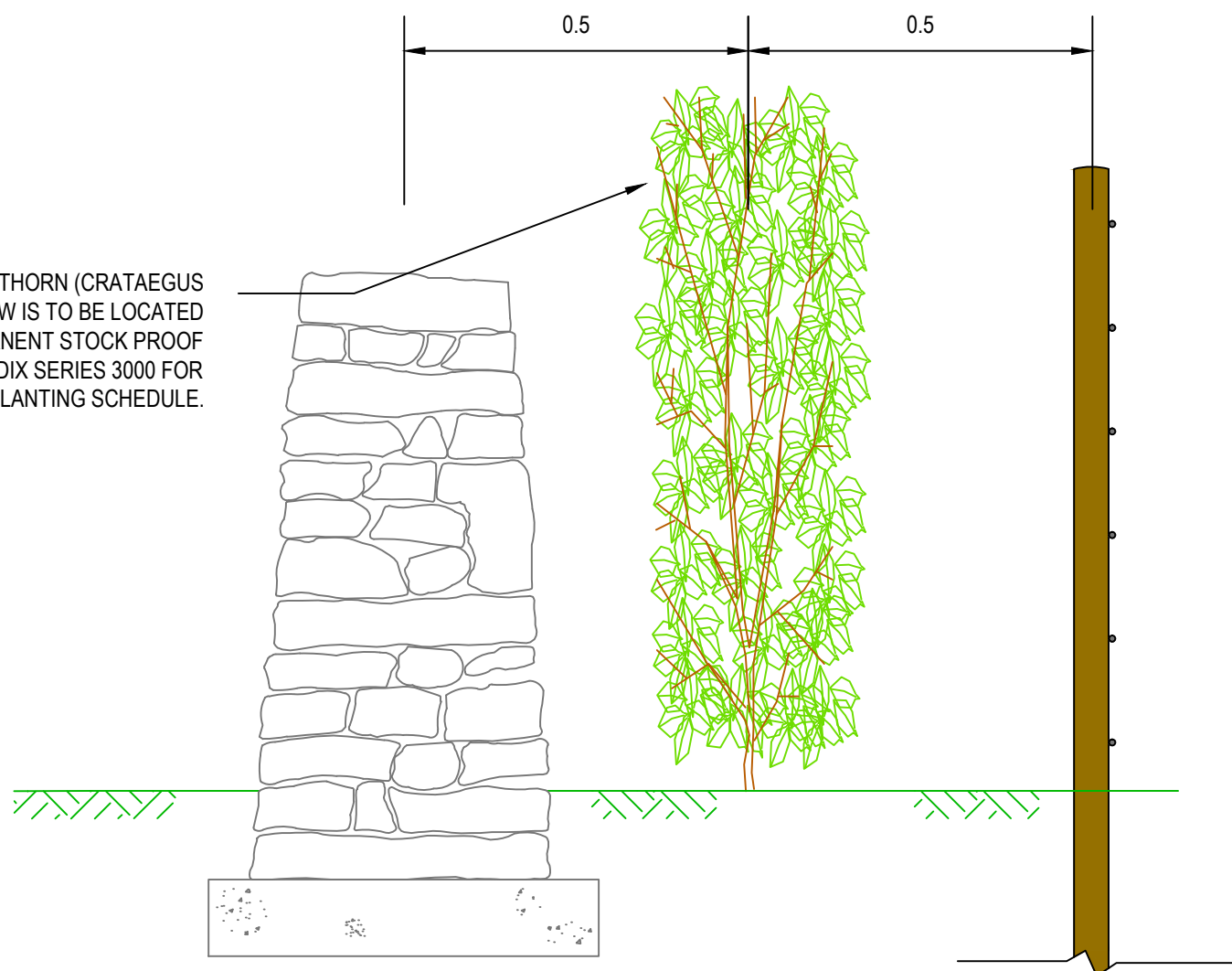

TYPICAL STONE WALL, HEDGEROW AND TIMBER POST & WIRE BOUNDARY FEATURE (Not to Scale)

1.0	MARCH 2018	FOR DCO SUBMISSION	HNPWL	HNPWL	HNPWL
Rev	Rev. Date	Purpose of revision	Drawn	Checked	Apprv'd

ILLUSTRATIVE

HORIZON
NUCLEAR POWER

Sunrise House, 1420 Charlton Court, Gloucester Business Park, Gloucester, GL3 4AE, UK
Freephone: 0845 300 6816 Email: info@horizonnuclearpower.com

Project
**WYLFA NEWYDD
DCO PROJECT**

Drawing Title
**A5025 OFF-LINE HIGHWAY IMPROVEMENTS
STANDARD DETAILS
BOUNDARY DETAILS**

Regulation 5 (2) (o)

Security Status NOT PROTECTIVELY MARKED					
Scale	Not to Scale	Sheet Size	A1	Sheet(s)	1 of 1
Drawing Number	WN0902-HZDCO-OHW-DRG-00068				Rev 1.0

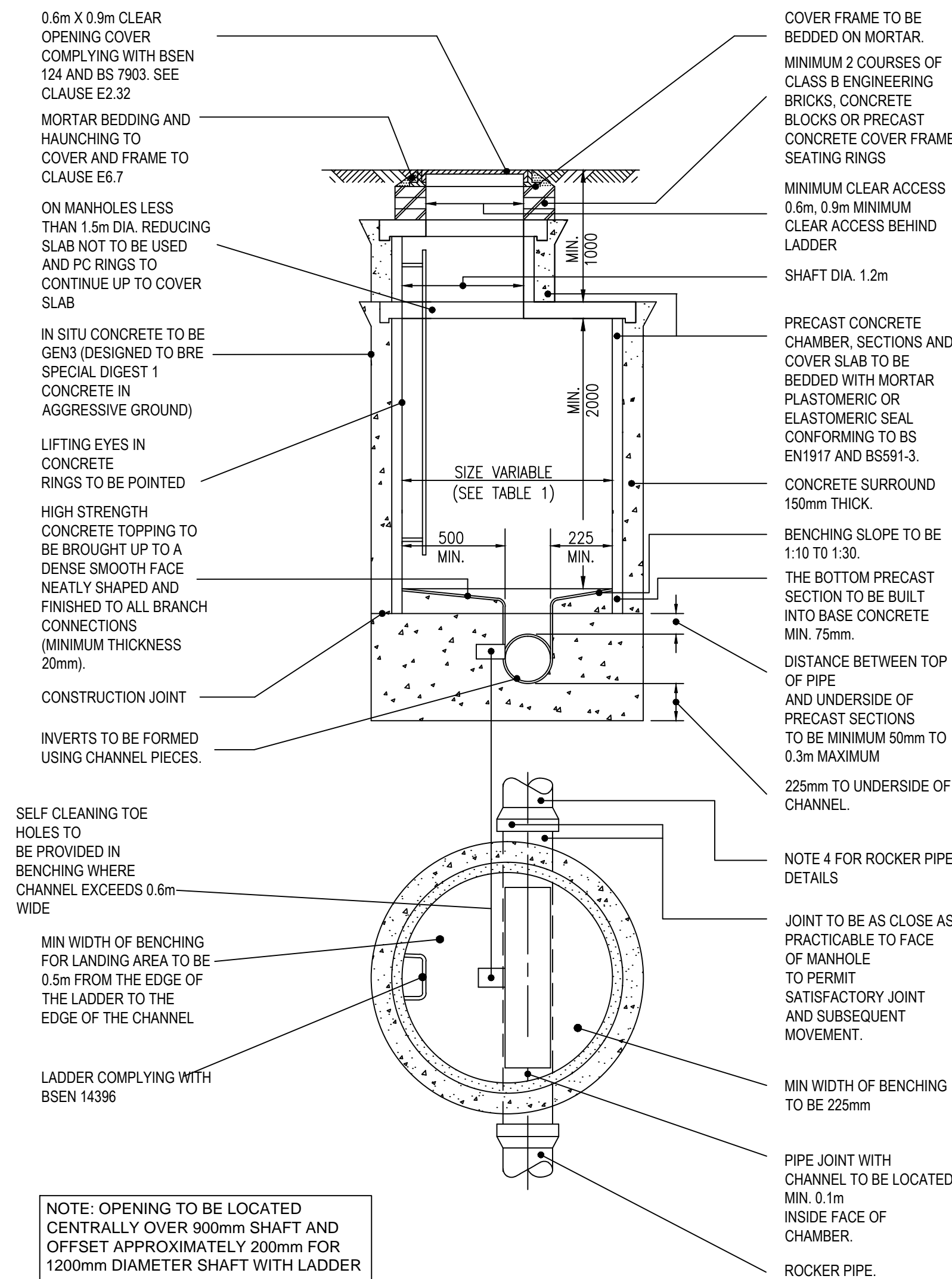

TYPICAL MANHOLE DETAIL - TYPE 1A
(DEPTH FROM COVER LEVEL TO SOFFIT OF PIPE 3.0m - 6.0m)
(Not to Scale)

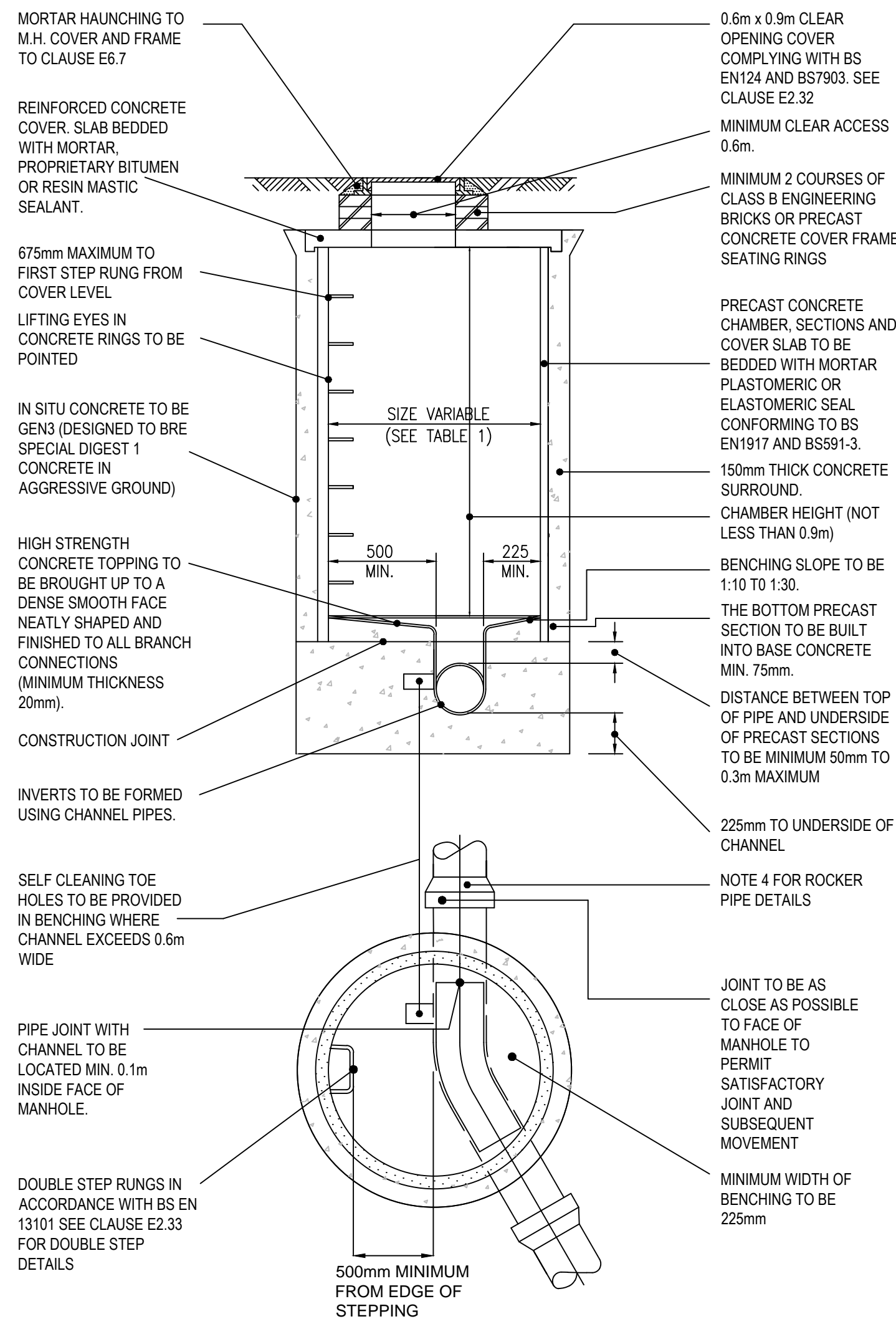

TYPICAL MANHOLE DETAIL - TYPE 2
(MAXIMUM DEPTH FROM COVER LEVEL TO SOFFIT OF PIPE 3m)
(Not to Scale)

1. All dimensions in metres unless stated otherwise.
2. This drawing should only be read in relation to the subject of the title, reference should be made to the appropriate drawing series for other information.
3. All materials and workmanship to be in accordance with the specification for highway works unless stated otherwise.
4. All drains up to and including DN300 size to be vitrified clay. All drains over and including size DN375 to be concrete (unless noted otherwise). Alternative materials may be substituted as detailed in SHW 100 series.
5. The length of the next pipe (rocker pipe) away from structures shall be:

Table 1 rocker pipe lengths

Pipe diameter (mm)	Length (m)
DN150 - DN600	0.6
DN675 - DN750	1.0
DN825 +	1.25

6. Only written dimensions are to be used.
7. Concrete benching and pipe surround shall be placed in single continuous operation from top of base slab.
8. Surface water connections shall be constructed with soffits level unless shown otherwise.
9. Cut ends of reinforced concrete pipes shall be treated with epoxy resin paint/mortar.
10. Manholes are to be to sewers for adoption 7th edition. Manhole sizes shall be (unless noted otherwise in manhole schedules):

Table 2 manhole diameters

Diameter of largest pipe in manhole (mm)	Internal diameter (mm)
<375	1200
375-450	1350
500-700	1500
750-900	1800
>900	Pipe diameter + 900

1.0	MARCH 2018	FOR DCO SUBMISSION	HNPWL	HNPWL	HNPWL
Rev	Rev. Date	Purpose of revision	Drawn	Checked	Appr'd

FOR INFORMATION

HORIZON
NUCLEAR POWER

Sunrise House, 1420 Charlton Court, Gloucester Business Park, Gloucester, GL3 4AE, UK
Freephone: 0845 300 6816 Email: info@horizonnuclearpower.com

Project

WYLFA NEWYDD
DCO PROJECT

Drawing Title

A5025 OFF-LINE HIGHWAY IMPROVEMENTS

STANDARD DETAILS

DRAINAGE

SHEET 2

Regulation 5 (2) (o)

Security Status
NOT PROTECTIVELY MARKED

Scale	Not to Scale	Sheet Size	A1	Sheet(s)	1 of 1
-------	--------------	------------	----	----------	--------

Drawing Number	Rev
WN0902-HZDCO-OHW-DRG-00070	1.0